

54-410 Warning device for seat belt, ignition key, light

The warning unit comprises 3 functions:

- 1st warning when seat belt is not put on
- 2nd warning when ignition key is not pulled off
- 3rd warning when light is not switched off

Operation

1. If with the ignition switched on and the driver's door closed (door contact switch left [S17/1 or S17/3] opened) the seat belt is not put on by driver, the warning buzzer will sound for 4–8 seconds. In such a case, the electronic system of the warning unit (N2/4) will connect positive current to warning buzzer in warning unit via closed belt switch.

When the seat belt is put on, the belt switch interrupts the circuit and the warning buzzer is switched off.

Belt warning lamp up to model year 1985

The indicator lamp connected in parallel with belt switch is operational up to end of respective period (4–8 seconds).

Belt warning lamp as of model year 1986

A belt warning lamp is installed to remind about using the safety belt. It flashes irrespective of whether the belt is used or not. The belt warning lamp is controlled by the door contact switch and the delayed electronics of the dome lamp. With the front door opened, the belt warning lamp flashes continuously, with the switch of the dome lamp in position „0“ only with the ignition switched on (key position 2).

When the front door is closed, the belt warning lamp continues to flash for 12 ± 1 seconds. This time is reduced to 6 ± 1 seconds by switching on the ignition (key position 2). If the ignition is again switched on after this period of time (key position 2), the belt warning lamp flashes once again for 6 ± 1 seconds.

2. If the ignition key is not pulled off with the driver's door open (door contact switch left S17/1 or S17/3 closed), the warning buzzer is activated by the electronics with plus via the closed warning buzzer contact on the ignition lock S8/2. The warning buzzer is switched off by pulling off the ignition key or after 4–8 seconds.

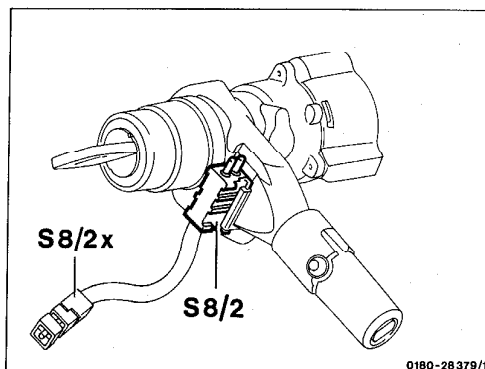

54-410 Warning device for seat belt, ignition key, light

Sedan as of model year 1986

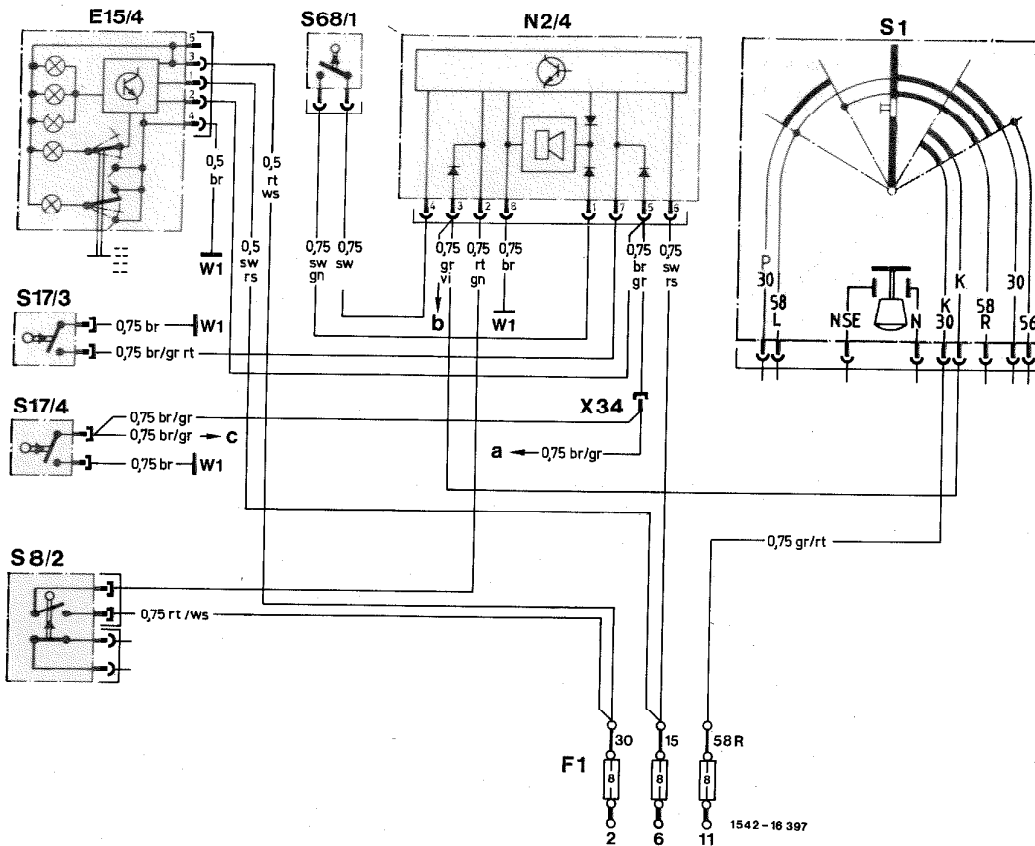

- E15/4 Dome lamp with reading lamp and belt warning
- F1 Fuse and relay box
- N2/4 Belt warning module
- S1 Rotary light switch
- S8/2 Warning buzzer contact lighting/central locking system
- S17/3 Front left door contact switch

- S17/4 Front right door contact switch
- S68/1 Belt buckle switch, driver (belt extender/belt warning)
- W1 Main ground (behind instrument cluster)
- X34 Intermediate connector door contact switch, front right
- a Entrance lamp E17/3 front left
- b Bulb failure monitoring unit N7 jack 16
- c Entrance lamp E17/4 front right

1542-16 397

54-410 Warning device for seat belt, ignition key, light

Coupe as of model year 1986

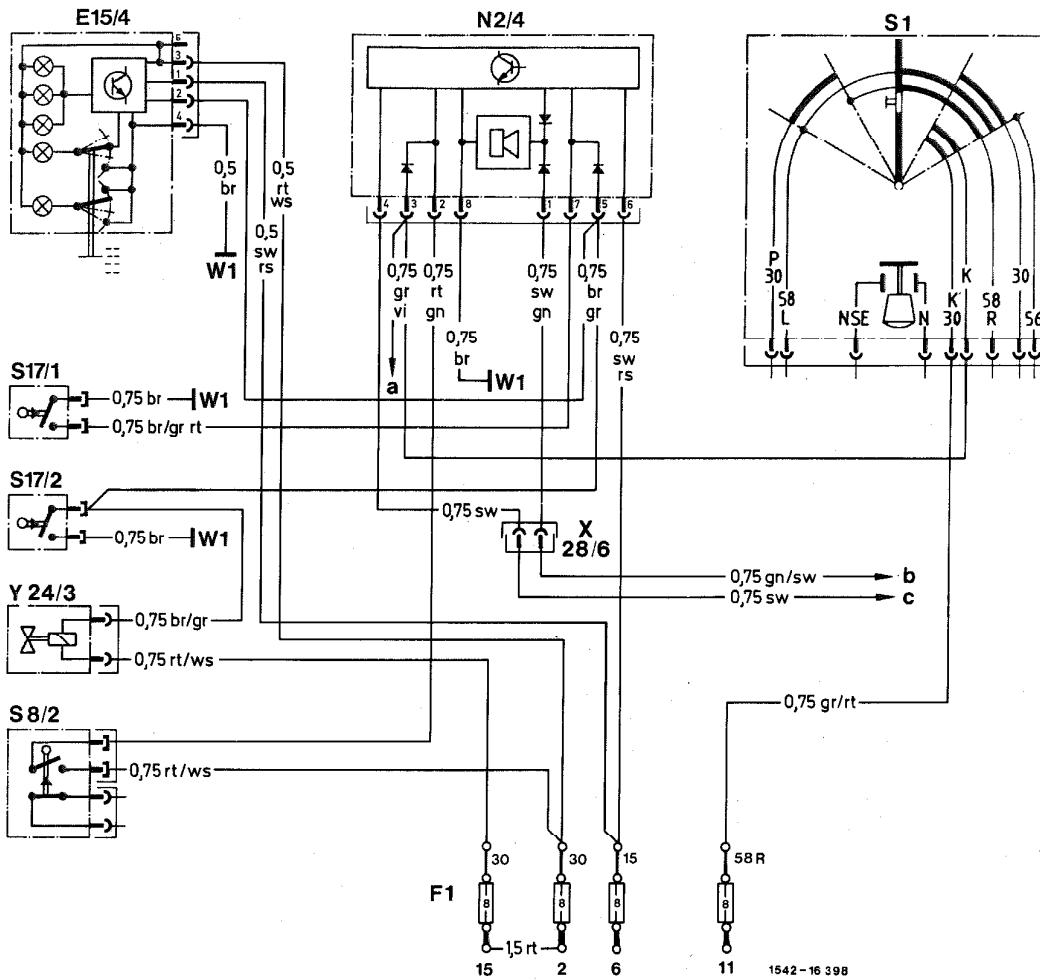

- E15/4 Dome lamp with reading lamp and belt warning
- F1 Fuse and relay box
- N2/4 Belt warning module
- S1 Rotary light switch
- S8/2 Warning buzzer contact lighting/central locking system
- S17/1 Door contact switch left
- S17/2 Door contact switch right

- W1 Main ground (behind instrument cluster)
- X28/6 Connector belt warning/relay belt warning
- Y24/3 Valve/seat backrest lock
- a Bulb failure monitoring unit N 7 jack 16
- b Relay belt warning device K 18 jack 3
- c Relay belt warning device K 18 jack 1